

YT 860

EQUIVALENTS OF CRANE TYPE 6



Technical features

- Single seal
- Unbalanced
- Single spring
- Bi-directional
- Elastomer bellows
- Equivalent to John Crane type 6, Pac-seal type 16, US Seal type A

Operating limits

- $d_1 = 3/8 - 1"$
- $p_1 = 0.8 \text{ MPa}$
- $t = -40 - 205 \text{ }^\circ\text{C}$
- $v_g = 15 \text{ m/s}$

Materials

- Seal faces: carbon graphite (resin-impreg.), silicon carbide, tungsten carbide
- Stationary seats: alumina ceramic, Ni-resist, silicon carbide, tungsten carbide
- Bellows: Neoprene, NBR, FPM, EPDM
- Springs, other metal components: AISI 304, 316, 316Ti
- Secondary seals: Neoprene, NBR, FPM, EPDM

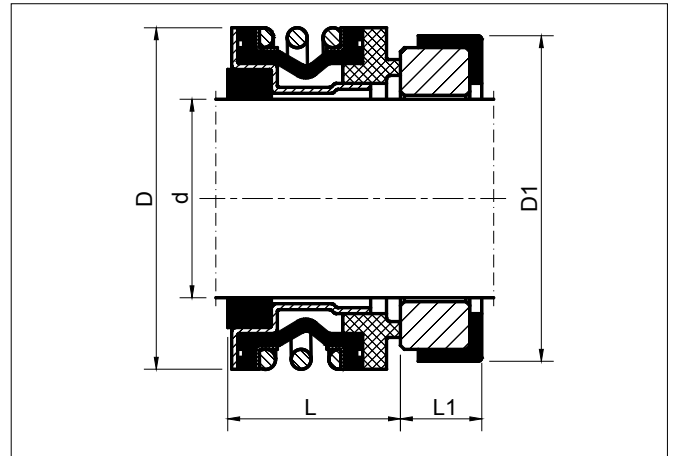

| d | D | D1 | L | L1 |
|--------|-------|-------|-------|-------|
| 0.375a | 0.917 | 0.875 | 0.656 | 0.250 |
| 0.375b | 0.917 | 1.000 | 0.656 | 0.312 |
| 0.437 | 0.917 | 1.000 | 0.656 | 0.312 |
| 0.500a | 0.917 | 1.000 | 0.656 | 0.250 |
| 0.500b | 0.917 | 1.000 | 0.656 | 0.312 |
| 0.625a | 1.185 | 1.250 | 0.718 | 0.343 |
| 0.625b | 1.185 | 1.187 | 0.718 | 0.406 |
| 0.625c | 1.185 | 1.250 | 0.812 | 0.406 |
| 0.750a | 1.302 | 1.375 | 0.718 | 0.406 |
| 0.750b | 1.302 | 1.375 | 0.812 | 0.406 |
| 0.875 | 1.429 | 1.500 | 0.812 | 0.406 |
| 1.000 | 1.552 | 1.625 | 0.812 | 0.437 |

Other seat dimensions are available pending request.
 Dimensions in inches.