

YT 852

EQUIVALENTS OF CRANE TYPE 502



Technical features

- Single seal
- Unbalanced
- Single spring
- Bi-directional
- Elastomer bellows
- To DIN 24960
- Equivalent to John Crane type 502

Operating limits

- $d_1 = 14 - 100 \text{ mm}$
- $p_1 = 4.0 \text{ MPa}$
- $t = -40 - 205 \text{ }^\circ\text{C}$
- $v_g = 13 \text{ m/s}$

Materials

- Seal faces: carbon graphite (resin-impreg.), silicon carbide, tungsten carbide
- Stationary seats: alumina ceramic, silicon carbide, tungsten carbide
- Bellows: NBR, FPM, EPDM
- Springs, other metal components: AISI 304, 316, 316Ti
- Secondary seals: NBR, FPM, EPDM

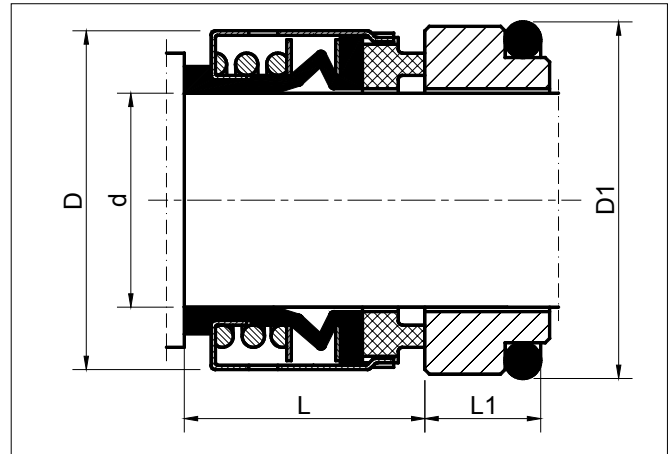

d	D	D1	L	L1
14	24	25	23.0	12.0
16	26	27	23.0	12.0
18	32	33	24.0	13.5
20	34	35	24.0	13.5
22	36	37	24.0	13.5
24	38	39	26.7	13.5
25	39	40	27.0	13.0
28	42	43	30.0	12.5
30	44	45	30.5	12.0
32	46	48	30.5	12.0
33	47	48	30.5	12.0
35	49	50	30.5	12.0
38	54	56	32.0	13.0
40	56	58	32.0	13.0
43	59	61	32.0	13.0
45	61	63	32.0	13.0
48	64	66	32.0	13.0
50	66	70	34.0	13.5
53	69	73	34.0	13.5
55	71	75	34.0	13.5
58	78	78	39.0	13.5
60	80	80	39.0	13.5
63	83	83	39.0	13.5
65	85	85	39.0	13.5
68	88	90	39.0	13.5
70	90	92	45.5	14.5
75	95	97	45.5	14.5
80	104	105	45.0	15.0
85	109	110	45.0	15.0
90	110	115	50.0	15.0
95	119	120	50.0	15.0
100	124	125	50.0	15.0

Conform to DIN 24960 L_{IK} length standard.

Dimensions in mm.