

YT 822

ELASTOMER BELLOWS SINGLE SEAL

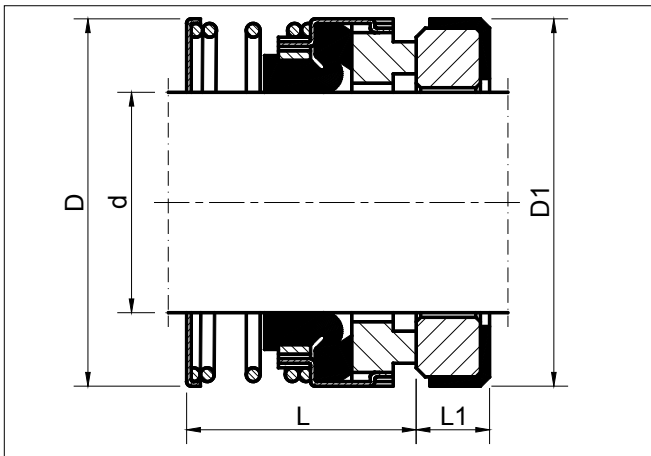

Technical features

- Single seal
- Unbalanced
- Single spring
- Bi-directional
- Elastomer diaphragm
- To DIN 24960

Operating limits

- $d_1 = 14 - 90$ mm
- $p_1 = 1.0$ MPa
- $t = -40 - 205$ °C
- $v_g = 15$ m/s

Materials

- Seal faces: carbon graphite (resin-impreg.), silicon carbide, tungsten carbide
- Stationary seats: alumina ceramic, Ni-resist, silicon carbide, tungsten carbide
- Bellows: Neoprene, NBR, FPM, EPDM
- Springs, other metal components: AISI 304, 316, 316Ti
- Secondary seals: Neoprene, NBR, FPM, EPDM

d	D	D1	L	L1
14	26.5	30	18.7	5.0
16	28.0	32	21.0	5.0
18	29.5	35	22.5	7.5
20	31.6	35	21.0	8.0
25	40.0	40	25.5	8.0
28	42.5	43	25.5	8.0
30	45.0	45	25.5	9.0
32	47.5	48	33.5	9.0
33	47.5	48	33.5	9.0
35	50.0	50	33.5	9.0
38	54.5	56	33.5	9.0
40	57.0	58	33.5	9.0
43	60.5	61	33.5	9.5
45	63.0	63	38.0	9.5
48	64.0	66	38.0	9.5
50	67.8	70	38.0	9.5
53	71.0	73	41.0	9.5
55	74.0	75	41.0	9.5
58	80.0	78	42.0	9.5
60	82.5	80	42.0	9.5
65	85.0	85	42.0	10.0
70	92.0	92	45.0	11.0
80	105.0	104	55.0	12.0
85	110.0	109	64.2	12.0
90	115.0	111	66.2	12.0

Dimensions in mm.