

YT 355

EQUIVALENTS OF BT-BURGMANN FN / ROTEN 3

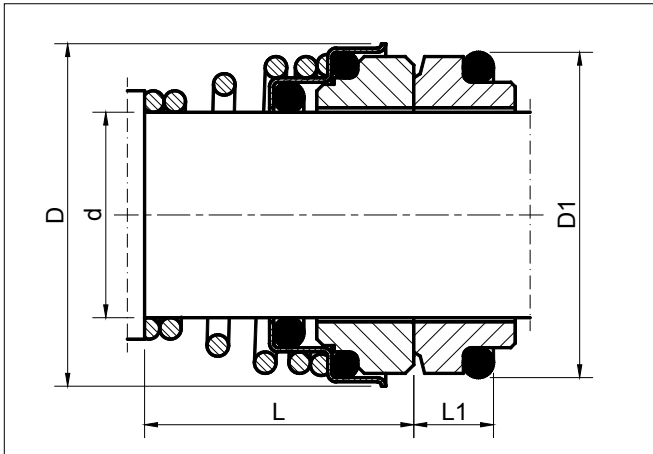

Technical features

- Single seal
- Unbalanced
- Conical spring
- Uni-directional
- Equivalent to BT-Burgmann FN, Roten type 3

Operating limits

- $d_1 = 10 - 40$ mm
- $p_1 = 1.0$ MPa
- $t = -20 - 180$ °C
- $v_g = 20$ m/s

Materials

- Seal faces: alumina ceramic, silicon carbide, Cr-Mo steel
- Stationary seats: carbon graphite (resin-impreg.), silicon carbide
- Springs, collars: AISI 304, 316, 316Ti
- Secondary seals: NBR, FPM, EPDM

| d | D | D1 | L | L1 |
|----|----|------|----|------|
| 10 | 20 | 18.1 | 15 | 5.5 |
| 11 | 22 | 20.6 | 18 | 5.5 |
| 12 | 22 | 20.6 | 18 | 5.5 |
| 13 | 25 | 23.1 | 22 | 6.0 |
| 14 | 25 | 23.1 | 22 | 6.0 |
| 15 | 29 | 26.9 | 22 | 7.0 |
| 16 | 29 | 26.9 | 23 | 7.0 |
| 17 | 29 | 26.9 | 23 | 7.0 |
| 18 | 33 | 30.9 | 24 | 8.0 |
| 19 | 33 | 30.9 | 25 | 8.0 |
| 20 | 33 | 30.9 | 25 | 8.0 |
| 22 | 38 | 35.4 | 25 | 8.0 |
| 24 | 38 | 35.4 | 27 | 8.0 |
| 25 | 40 | 38.2 | 27 | 8.5 |
| 28 | 46 | 43.3 | 29 | 9.0 |
| 30 | 46 | 43.3 | 30 | 9.0 |
| 32 | 46 | 43.3 | 30 | 9.0 |
| 35 | 50 | 53.5 | 39 | 11.5 |
| 38 | 55 | 60.5 | 39 | 11.5 |
| 40 | 55 | 60.5 | 39 | 11.5 |

Dimensions in mm.